

● (in loft)

KEY	
	illuminated exit sign
	emergency luminaire
	fire sounder
	call point
	fire extinguisher
	smoke/heat detector
	fire alarm panel
	fire door
	refuge point

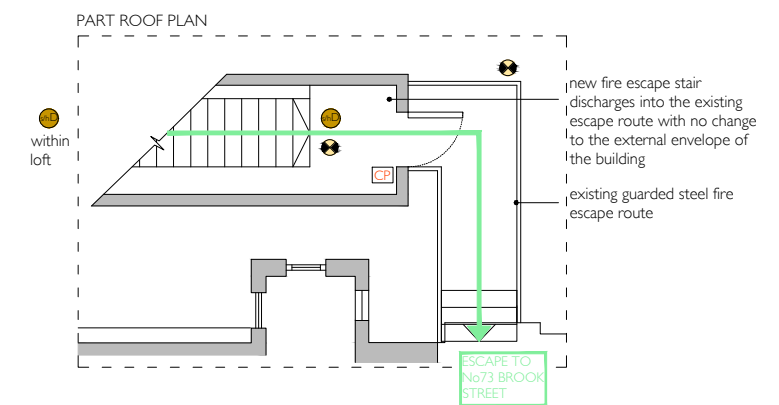

- GENERAL NOTES
- DO NOT SCALE FROM THIS DRAWING
 - THE DIMENSIONS SHOWN ON THIS DRAWING HAVE BEEN BASED ON THE DIMENSIONS TAKEN BY ROUGH SITE MEASUREMENTS.
 - ALL LEVELS AND DIMENSIONS TO BE CHECKED ON SITE AND ANY DISCREPANCIES NOTED TO THE ARCHITECT IMMEDIATELY.
 - THIS DRAWING IS TO BE READ IN CONJUNCTION WITH ALL RELEVANT CONSULTANTS' DRAWINGS AND SPECIFICATIONS.
 - THIS DRAWING IS COPYRIGHT AND MUST NOT BE REPRODUCED WITHOUT THE PRIOR WRITTEN AGREEMENT OF THE ARCHITECT.

REVISIONS

NO.	DATE	BY	REASON
A	08 07 13	KOB	COORDINATED WITH SOLOMON ELECTRICAL SERVICES LTD
B	11 12 13	KOB	UPDATED
C	07 05 14	KOB	REFUGE POINTS SHOWN
D	07 03 19	DG	UPDATED

FILE NO: N:\1527 Savile Club\drawings\series\lics series\L(lics)06.dwg
 N:\1527 Savile Club\drawings\series\plan\sv_404.dwg

PROJECT: 69 BROOK STREET LONDON W1

SUBJECT: LICENSING PLAN FOURTH FLOOR

SCALE: 1:50@A1 DATE: 06 13 JOB NO: L1527 DRAWING NO: L(lics)06 REVISION: D

40 CHANCERY LANE LONDON WC2A 1JB 020 7421 1790 WWW.TREHEARNEARCHITECTS.CO.UK

TREHEARNEARCHITECTS

PROJECT: 69 BROOK STREET LONDON W1

SUBJECT: LICENSING PLAN FOURTH FLOOR

SCALE: 1:50@A1 DATE: 06 13 JOB NO: L1527 DRAWING NO: L(lics)06 REVISION: D

40 CHANCERY LANE LONDON WC2A 1JB 020 7421 1790 WWW.TREHEARNEARCHITECTS.CO.UK